

- GENERAL NOTES:**
- THE ENGINEER SHALL NOT BE RESPONSIBLE FOR THE SUPERVISION OF THE CONSTRUCTION.
  - NO CHANGES SHALL BE MADE TO THESE PLANS EXCEPT AS PER NYS LAW CHAPTER 987.
  - ALL WORK AND MATERIALS SHALL COMPLY WITH ALL APPLICABLE CODES, INCLUDING BUT NOT LIMITED TO A.C.I., A.S.C., ZONING, AND THE NEW YORK STATE BUILDING CODE.
  - ALL CONDITIONS, LOCATIONS AND DIMENSIONS SHALL BE FIELD VERIFIED AND THE ENGINEER SHALL BE IMMEDIATELY NOTIFIED OF ANY DISCREPANCIES.
  - ALL CHANGES MADE TO THE PLANS SHALL BE APPROVED BY THE ENGINEER AND ANY SUCH CHANGES SHALL BE FILED AS AMENDMENTS TO THE ORIGINAL BUILDING PERMIT.
  - THE CONTRACTOR SHALL SUPERVISE AND DIRECT THE WORK USING HIS BEST SKILL AND ATTENTION. HE SHALL BE SOLELY RESPONSIBLE FOR ALL CONSTRUCTION MEANS, METHODS, TECHNIQUES, SEQUENCES AND PROCEDURES AND FOR COORDINATING ALL PORTIONS OF THE WORK UNDER THE CONTRACT.
  - THE CONTRACTOR SHALL BE RESPONSIBLE TO THE OWNER FOR THE ACTS AND OMISSIONS OF HIS EMPLOYEES, SUBCONTRACTORS AND THEIR AGENTS AND EMPLOYEES, AND OTHER PERSONS PERFORMING ANY OF THE WORK UNDER A CONTRACT WITH THE CONTRACTOR.
  - SAFETY DURING CONSTRUCTION SHALL BE THE RESPONSIBILITY OF THE CONTRACTOR AND SHALL CONFORM TO ALL LOCAL, STATE AND FEDERAL AGENCIES IN EFFECT DURING THE PERIOD OF CONSTRUCTION.
  - THE CONTRACTOR AND HIS SUBCONTRACTORS SHALL MAKE APPLICATION TO RECEIVE ALL NECESSARY PERMITS TO PERFORM THE WORK UNDER CONTRACT. THE CONTRACTOR AND HIS SUBCONTRACTORS SHALL BE LICENSED TO DO ALL WORK AS REQUIRED BY THE LOCAL, COUNTY, AND STATE AGENCIES WHICH MAY HAVE JURISDICTION OVER THOSE TRADES, AND SHALL PRESENT THE OWNER WITH COPIES OF ALL LICENSES AND INSURANCE CERTIFICATES.
  - FINAL GRADING AROUND THE BUILDING AREA SHALL SLOPE AWAY FROM THE STRUCTURE.
  - ALL WRITTEN DIMENSIONS ON THE DRAWINGS SHALL TAKE PRECEDENCE OVER ANY SCALED DIMENSIONS.
  - ADJOINING PUBLIC AND PRIVATE PROPERTY SHALL BE PROTECTED FROM DAMAGE DURING CONSTRUCTION, REMODELING AND DEMOLITION WORK. PROTECTION MUST BE PROVIDED FOR FOOTINGS, FOUNDATIONS, PARTY WALLS, CHIMNEYS, SKYLIGHTS AND ROOFS. PROVISIONS SHALL BE MADE TO CONTROL WATER RUNOFF AND EROSION DURING CONSTRUCTION OR DEMOLITION ACTIVITIES. THE PERSON MAKING OR CAUSING AN EXCAVATION TO BE MADE SHALL PROVIDE WRITTEN NOTICE TO THE OWNERS OF ADJOINING BUILDINGS ADVISING THEM THAT THE EXCAVATION IS TO BE MADE AND THAT THE ADJOINING BUILDING SHOULD BE PROTECTED. SAID NOTIFICATION SHALL BE DELIVERED NOT LESS THAN 10 DAYS PRIOR TO THE SCHEDULED STARTING DATE OF THE EXCAVATION.
  - OWNER SHALL INSURE THAT THE INSURANCE PROVIDED BY THE CONTRACTOR HIRED TO PERFORM THE WORK SHALL BE ENDORSED TO NAME HUDSON ENGINEERING & CONSULTING, P.C., AND ANY DIRECTORS, OFFICERS, EMPLOYEES, SUBSIDIARIES, AND AFFILIATES, AS ADDITIONAL INSURED ON ALL POLICIES AND HOLD HARMLESS DOCUMENTS, AND SHALL STIPULATE THAT THIS INSURANCE IS PRIMARY, AND THAT ANY OTHER INSURANCE OR SELF-INSURANCE MAINTAINED BY HUDSON ENGINEERING & CONSULTING, P.C., SHALL BE EXCESS ONLY AND SHALL NOT BE CALLED UPON TO CONTRIBUTE WITH THIS INSURANCE. ISO ADDITIONAL INSURED ENDORSEMENT FORM NUMBER C02010 1185 UNDER GL. COPIES OF THE INSURANCE POLICIES SHALL BE SUBMITTED TO HUDSON ENGINEERING & CONSULTING, P.C., FOR APPROVAL PRIOR TO THE SIGNING OF THE CONTRACT.
  - INDUSTRIAL CODE RULE 753: THE CONTRACTOR SHALL NOTIFY ALL UTILITY COMPANIES 72 HOURS PRIOR TO THE START OF HIS OPERATIONS AND SHALL COMPLY WITH ALL THE LATEST INDUSTRIAL CODE RULE 753 REGULATIONS.

ZONING ANALYSIS TABLE		
SECTION: 6.30	DISTRICT: R-1	
BLOCK: 14		
LOT: 45.2		
REGULATION	REQ'D	PROPOSED
Lot size (s.f.)	40,000	38,470.00
Min. Lot Width (ft.)	150	144.91
Min. Frontage (ft.)	100	151.85
Min. Yards		
- Front (ft.)	40	40.50
- Side 1 (ft.)	30	30.80
- Side 2 (ft.)	30	35.70
- Rear (ft.)	40	133.70
Building Height	30 ft	30 ft
Max. Bldg. Coverage (%)	12%	8.40%
Max. Bldg. Coverage (sq. ft.)	4616.4	3233.0
Max. Impervious Cov. (s.f.)	6716.4	4891.0

ANY ALTERATIONS OR REVISIONS OF THESE PLANS, UNLESS DONE BY OR UNDER THE DIRECTION OF THE NYS LICENSED AND REGISTERED ENGINEER THAT PREPARED THEM, IS A VIOLATION OF THE NYS EDUCATION LAW.

13 DELLWOOD LANE SITE PLAN BASED UPON EXISTING INFORMATION PROVIDED BY WARD CARPENTER ENGINEERS INC., DATED DECEMBER 30, 2020

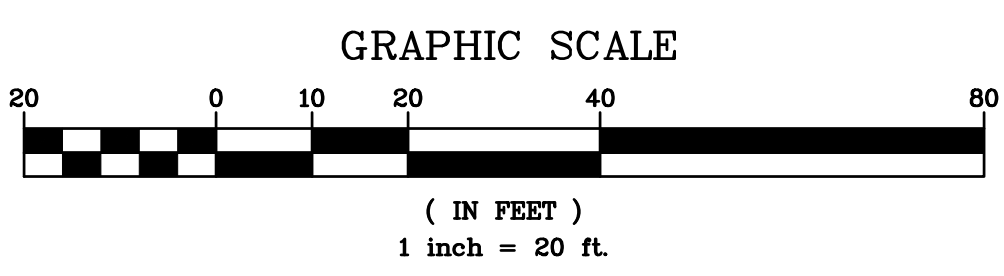

REVISIONS 03/27/22 U.A.	PROJECT:	PROPOSED DWELLING 13 DELLWOOD LANE VILLAGE OF ARDSLEY WESTCHESTER COUNTY – NEW YORK	
	THIS PLAN NOT VALID FOR CONSTRUCTION WITHOUT ENGINEER'S SEAL & SIGNATURE	SITE PLAN	
		 45 Knollwood Road, Suite 201 Elmsford, New York 10523 T: 914-909-0420 F: 914-560-2086	<b>C-1</b>

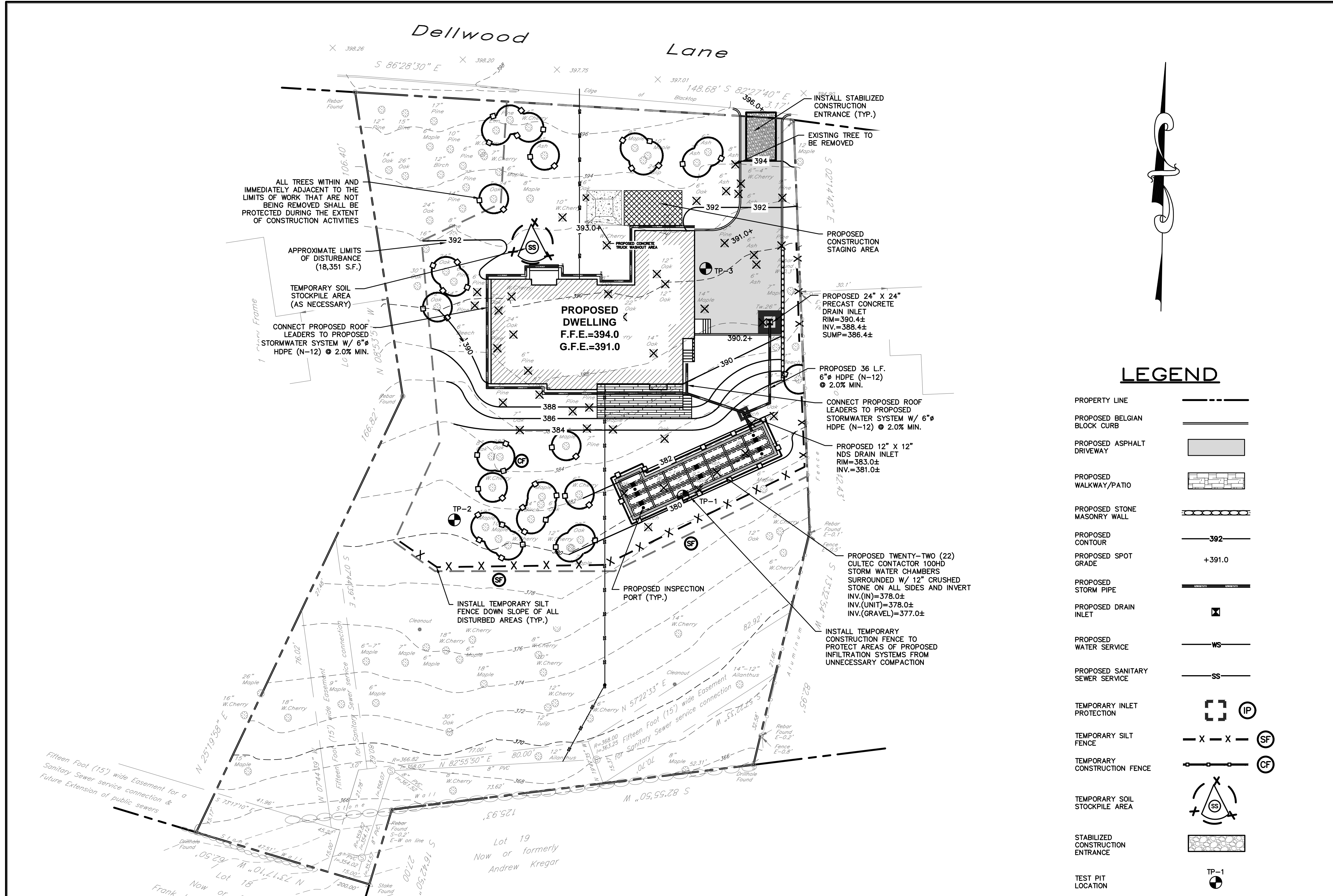

**STONE & BLOCK DROP INLET PROTECTION**

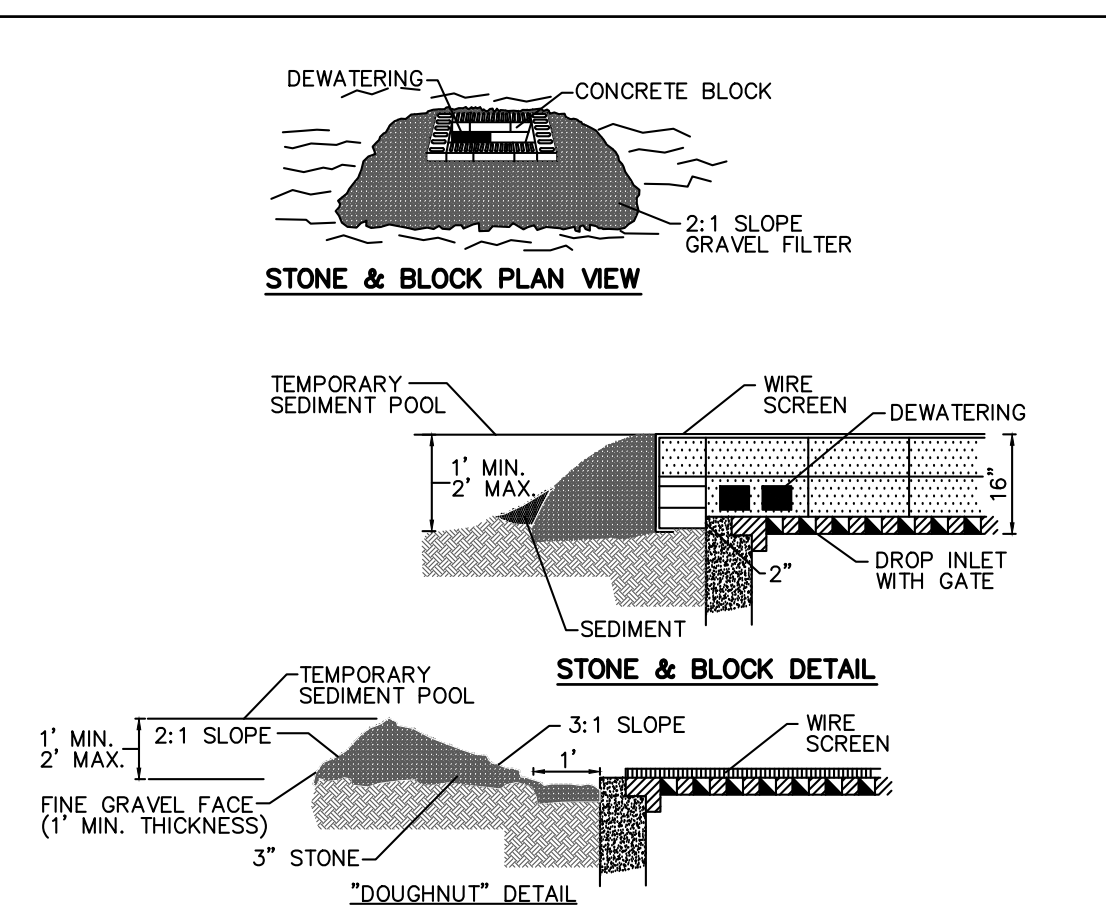

**CONSTRUCTION SPECIFICATION**

- LAY ONE BLOCK ON EACH SIDE OF THE STRUCTURE ON ITS SIDE FOR DEWATERING. FOUNDATION SHALL BE 2 INCHES MINIMUM BELOW REST OF INLET AND BLOCKS SHALL BE PLACED AGAINST INLET FOR SUPPORT.
- HARDWARECLOTH OR 1/2\" WIRE MESH SHALL BE PLACED OVER BLOCK OPENINGS TO SUPPORT STONE.
- USE CLEAN STONE OR GRAVEL 1/2-3/4 INCH IN DIAMETER PLACED 2 INCHES BELOW TOP OF BLOCK ON A 2:1 SLOPE OR FLATTER.
- FOR STONE STRUCTURES ONLY, A 1 FOOT THICK LAYER OF THE FILTER STONE WILL BE PLACED AGAINST THE 3 INCH STONE AS SHOWN ON THE DRAWINGS. MAXIMUM DRAINAGE AREA 1 ACRE.

**SOIL STOCKPILING**

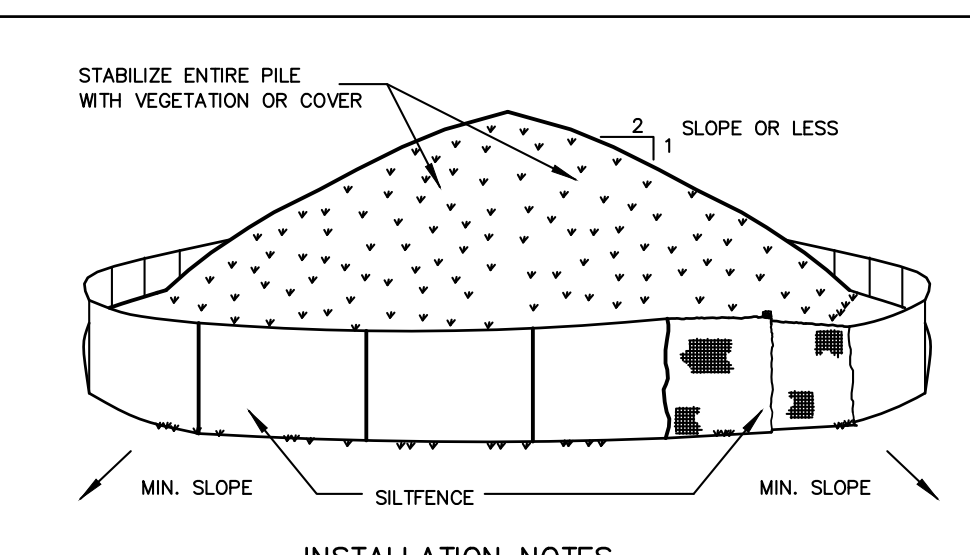

- INSTALLATION NOTES:**
- AREA CHOSEN FOR STOCKPILING OPERATIONS SHALL BE DRY AND STABLE.
  - SOILS OR FILL TO BE STOCKPILED ON SITE DURING CUTTING AND FILLING ACTIVITIES SHOULD BE LOCATED ON LEVEL PORTIONS OF THE SITE WITH A MINIMUM OF 50-75 FOOT SETBACKS FROM TEMPORARY DRAINAGE SWALES.
  - MAXIMUM SLOPE OF STOCKPILE SHALL BE 1:2.
  - UPON COMPLETION OF SOIL STOCKPILING EACH PILE SHALL BE SURROUNDED WITH EITHER SILT FENCING OR STRAWBALES, THEN STABILIZED WITH VEGETATION OR COVERED.
  - STOCKPILES REMAINING IN PLACE FOR MORE THAN A WEEK SHOULD BE SEEDED AND MULCHED OR COVERED WITH GEOTEXTILE FABRIC SURROUNDED BY SILT FENCE.
  - SEE SPECIFICATIONS (THIS MANUAL) FOR INSTALLATION OF SILT FENCE.

**SILT FENCE**

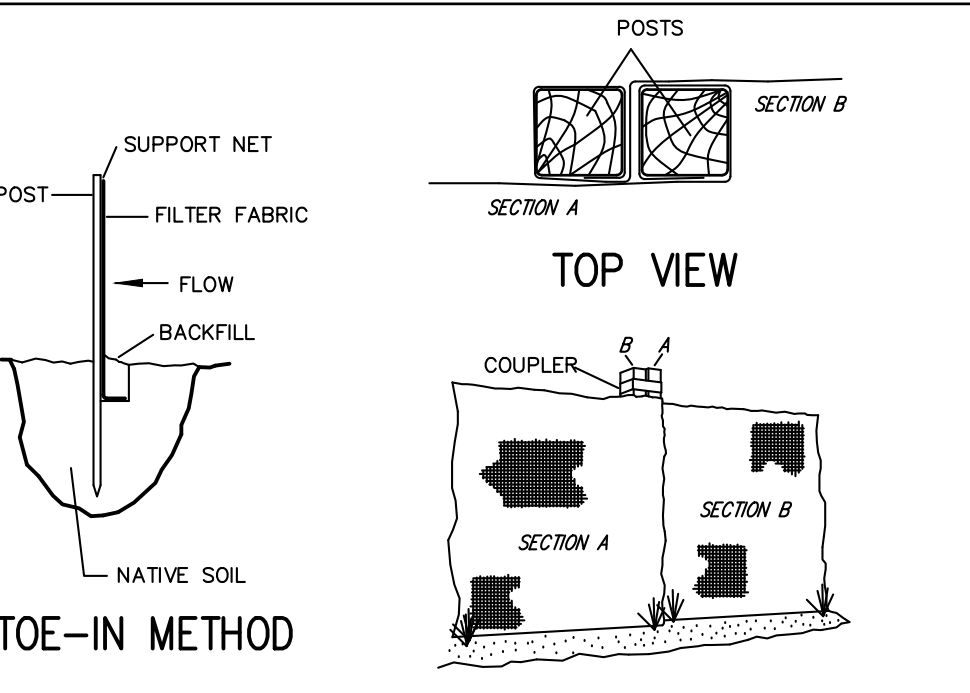

- INSTALLATION NOTES:**
- EXCAVATE A 4 INCH x 4 INCH TRENCH ALONG THE LOWER PERIMETER OF THE SITE.
  - UNROLL A SECTION AT A TIME AND POSITION THE POSTS AGAINST THE BACK (DOWNSTREAM) WALL OF THE TRENCH (NET SIDE AWAY FROM DIRECTION OF FLOW).
  - DRIVE THE POST INTO THE GROUND UNTIL THE NETTING IS APPROXIMATELY 2 INCHES FROM THE TRENCH BOTTOM.
  - LAY THE TOE-IN FLAP OF FABRIC ONTO THE UNDISTURBED BOTTOM OF THE TRENCH. BACKFILL THE TRENCH AND TAMP THE SOIL. STEEPER SLOPES REQUIRE AN INTERCEPT TRENCH.
  - JOIN SECTIONS AS SHOWN ABOVE.

**FENCING AND ARMORING**

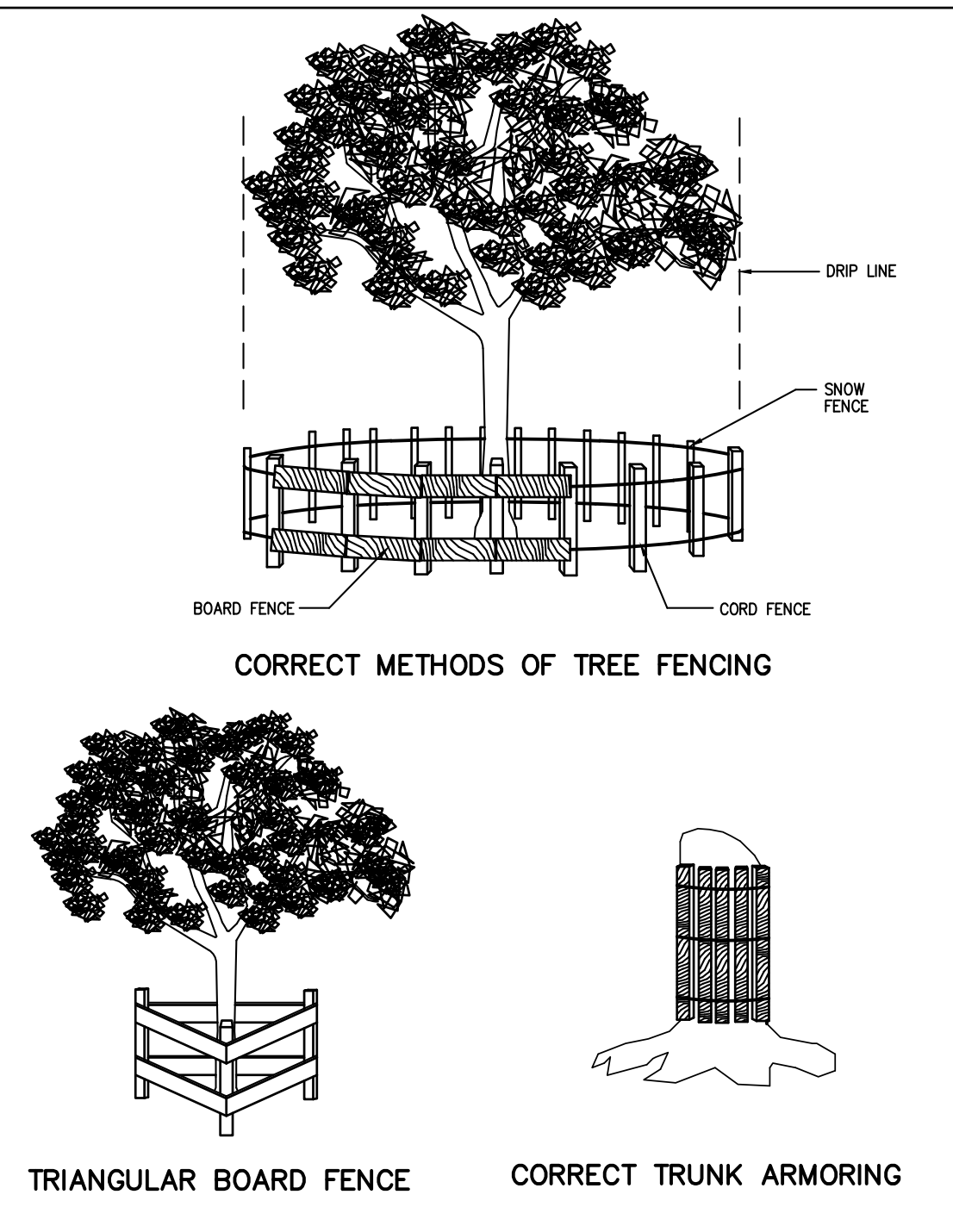

**TEST HOLE DATA:**

- TEST HOLE #1**  
 DEPTH - 64"  
 0-8\" ORGANIC SOIL  
 6-64\" LOOSELY COMPACT BROWN, FINE SANDY LOAM  
 NO GROUNDWATER  
 LEDGE ROCK @ 64"  
 PERC. = 9.5\" INCHES/HOUR
- TEST HOLE #2**  
 DEPTH - 48"  
 0-6\" ORGANIC SOIL  
 6-46\" LOOSELY COMPACT BROWN, FINE SANDY LOAM  
 NO GROUNDWATER  
 LEDGE ROCK @ 46"  
 PERC. = 25.75\" INCHES/HOUR
- TEST HOLE #3**  
 DEPTH - 48"  
 0-6\" ORGANIC SOIL  
 6-26\" MODERATELY COMPACT BROWN LOAM  
 26-48\" LOOSELY COMPACT BROWN, FINE SANDY LOAM  
 NO GROUNDWATER  
 LEDGE ROCK @ 48"

**LEGEND**

- PROPERTY LINE
- PROPOSED BELGIAN BLOCK CURB
- PROPOSED ASPHALT DRIVEWAY
- PROPOSED WALKWAY/PATIO
- PROPOSED STONE MASONRY WALL
- PROPOSED CONTOUR
- PROPOSED SPOT GRADE
- PROPOSED STORM PIPE
- PROPOSED DRAIN INLET
- PROPOSED WATER SERVICE
- PROPOSED SANITARY SEWER SERVICE
- TEMPORARY INLET PROTECTION
- TEMPORARY SILT FENCE
- TEMPORARY CONSTRUCTION FENCE
- TEMPORARY SOIL STOCKPILE AREA
- STABILIZED CONSTRUCTION ENTRANCE
- TEST PIT LOCATION
- PROPOSED LIMIT OF DISTURBANCE

**CONSTRUCTION SEQUENCING:**

- THE FOLLOWING EROSION CONTROL SCHEDULE SHALL BE UTILIZED:
  - INSTALL CONSTRUCTION ENTRANCE.
  - ESTABLISH CONSTRUCTION STAGING AREA.
  - INSTALL TREE PROTECTION ON TREES AS NOTED ON PLANS.
  - SELECTIVE VEGETATION REMOVAL FOR SILT FENCE INSTALLATION.
  - INSTALL SILT FENCE DOWN SLOPE OF ALL AREAS TO BE DISTURBED AS SHOWN ON THE PLAN.
  - REMOVE TREES WHERE NECESSARY (CLEAR & GRUB) FOR THE PROPOSED CONSTRUCTION.
  - STRIP TOPSOIL AND STOCKPILE AT THE LOCATIONS SPECIFIED ON THE PLANS (UP GRADIENT OF EROSION CONTROL MEASURES). TEMPORARILY STABILIZE TOPSOIL STOCKPILES (HYDROSEED DURING MAY 1ST THROUGH OCTOBER 31ST PLANTING SEASON OR BY COVERING WITH A TARP(AULIN(S) NOVEMBER 1ST THROUGH APRIL 30TH. INSTALL SILT FENCE AROUND TOE OF SLOPE.
  - ROUGH GRADE SITE.
  - INSTALL ADDITIONAL SILT FENCING AS NECESSARY.
  - ROUGH GRADE DRIVEWAY AND INSTALL TRENCH DRAIN AND CATCH BASINS AS WELL AS ALL ASSOCIATED ONSITE PIPING.
  - EXCAVATE AND CONSTRUCT FOUNDATIONS FOR NEW BUILDING.
  - BROADCAST 1.25 LB. BAG OF JONATHAN GREEN \"FASTGROW\" MIX OR EQUAL OVER AREA TO BE SEED. APPLY STRAW MULCH AND WATER WITHIN 2 DAYS OF COMPLETION OF TOPSOILING. CALL FOR INSPECTION FROM THE APPROPRIATE MUNICIPAL AGENCY HAVING JURISDICTION AT LEAST 2 DAYS PRIOR TO FINISH.
  - CONSTRUCT SUBSURFACE EXFILTRATION CHAMBERS.
  - CONSTRUCT BUILDING, INSTALL AND CONNECT ALL ROOF DRAIN LEADERS TO PREVIOUSLY INSTALLED NDS CATCH BASIN.
  - INSTALL CURBING, AND SUB-BASE COURSES. FINE GRADE AND SEED ALL DISTURBED AREAS. SPREAD SALT HAY OVER SEEDED AREAS.
  - INSTALL BITUMINOUS CONCRETE TOP COURSE.
  - CLEAN PAVEMENT, DRAIN LINES, CATCH BASINS, TRENCH DRAIN AND SUBSURFACE EXFILTRATION CHAMBERS.
  - REMOVE ALL TEMPORARY SOIL EROSION AND SEDIMENT CONTROL MEASURES AFTER SITE HAS ACHIEVED FINAL STABILIZATION (80% UNIFORM DENSITY OF PERMANENT VEGETATION OR PERMANENT MULCH/STONE).
- \* SOIL EROSION AND SEDIMENT CONTROL MAINTENANCE MUST OCCUR WEEKLY AND PRIOR TO AND AFTER EVERY 1/2\" OR GREATER RAINFALL EVENT.

**INSTALLATION & MAINTENANCE OF EROSION CONTROL:**

- CONSTRUCTION SCHEDULE**  
 NOTIFY APPROPRIATE MUNICIPAL AGENCY HAVING JURISDICTION AT LEAST 5 DAYS PRIOR TO START.
- EROSION CONTROL MEASURES**  
 INSTALL ALL EROSION CONTROL MEASURES PRIOR TO START OF CONSTRUCTION. CALL FOR INSPECTION FROM THE APPROPRIATE MUNICIPAL AGENCY HAVING JURISDICTION AT LEAST 2 DAYS PRIOR TO FINISH.
- INSPECTION BY MUNICIPALITY - MAINTENANCE (TO BE PERFORMED DURING ALL PHASES OF CONSTRUCTION)**  
 AFTER ANY RAIN CAUSING RUNOFF, CONTRACTOR TO INSPECT HAYBALES, ETC. AND REMOVE ANY EXCESSIVE SEDIMENT AND INSPECT STOCKPILES AND CORRECT ANY PROBLEMS WITH SEED ESTABLISHMENT. INSPECTIONS SHALL BE DOCUMENTED IN WRITING AND SUBMITTED TO THE APPROPRIATE MUNICIPAL AGENCY HAVING JURISDICTION.
- INSPECTION BY MUNICIPALITY - FINAL GRADING**  
 REMOVE UNNEEDED SUBGRADE FROM SITE. CALL FOR INSPECTION FROM THE APPROPRIATE MUNICIPAL AGENCY HAVING JURISDICTION AT LEAST 2 DAYS PRIOR TO FINISH.
- INSPECTION BY MUNICIPALITY - LANDSCAPING**  
 SPREAD TOPSOIL EVENLY OVER AREAS TO BE SEED. HAND RAKE LEVEL. BROADCAST 1.25 LB. BAG OF JONATHAN GREEN \"FASTGROW\" MIX OR EQUAL OVER AREA TO BE SEED. APPLY STRAW MULCH AND WATER WITHIN 2 DAYS OF COMPLETION OF TOPSOILING. CALL FOR INSPECTION FROM THE APPROPRIATE MUNICIPAL AGENCY HAVING JURISDICTION AT LEAST 2 DAYS PRIOR TO FINISH.
- INSPECTION BY MUNICIPALITY - FINAL LANDSCAPING**  
 GRASS ESTABLISHED. CALL FOR INSPECTION FROM THE APPROPRIATE MUNICIPAL AGENCY HAVING JURISDICTION AT LEAST 2 DAYS PRIOR TO FINISH.
- INSPECTION BY MUNICIPALITY - FINAL INSPECTION**  
 ALL EROSION CONTROL MEASURES REMOVED AND GRASS ESTABLISHED. CALL FOR INSPECTION FROM THE APPROPRIATE MUNICIPAL AGENCY HAVING JURISDICTION AT LEAST 2 DAYS PRIOR TO FINISH.

**NOTES:**

- PRIOR TO CONSTRUCTION, CONTRACTOR SHALL LOCATE ALL BURIED UTILITIES TO ENSURE THAT NO INTERFERENCE EXISTS DURING CONSTRUCTION ACTIVITIES.
- ANY IMPORTED SOIL SHALL COMPLY WITH ALL FEDERAL, STATE, AND LOCAL REQUIREMENTS FOR QUALITY AND USE.
- OF-SITE DISPOSAL OF EXCESS CUT SHALL BE IN ACCORDANCE WITH ALL FEDERAL, STATE, AND LOCAL REQUIREMENTS.

**Cut/Fill Summary**

Name	Cut	Fill	Net
Cut-Fill	797.45 Cu. Yd.	307.34 Cu. Yd.	490.10 Cu. Yd.<Cut>
APPROXIMATELY 236 C.F. OF ROCK CUT			

13 DELLWOOD LANE STORMWATER MANAGEMENT PLAN BASED UPON EXISTING INFORMATION PROVIDED BY WARD CARPENTER ENGINEERS INC., DATED DECEMBER 30, 2020

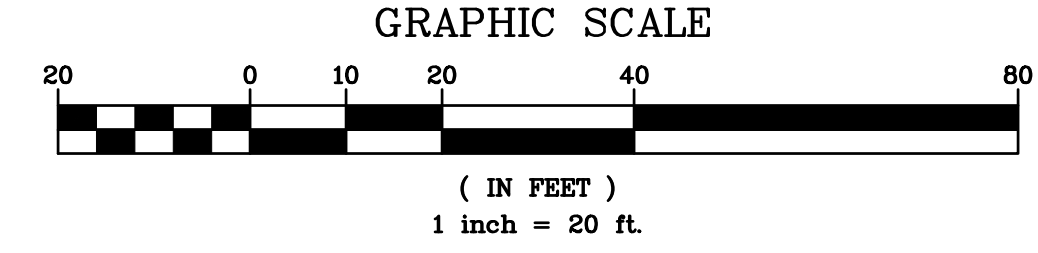

PROJECT: PROPOSED DWELLING 13 DELLWOOD LANE VILLAGE OF ARDSLEY WESTCHESTER COUNTY - NEW YORK

STORMWATER MANAGEMENT PLAN

HEC HUDSON ENGINEERING CONSULTING, P.C. 45 Knollwood Road, Suite 201 Elmford, New York 10523 T: 914-909-0420 F: 914-560-2086 © 2021

DATE: 07/07/21 SHEET: 2 OF 2  
 DESIGNED BY: U.A.  
 CHECKED BY: M.S.  
 SHEET NO. C-2

STATE OF NEW YORK MICHAEL J. STERN LICENSED PROFESSIONAL ENGINEER No. 60651

ANY ALTERATIONS OR REVISIONS OF THESE PLANS, UNLESS DONE BY OR UNDER THE DIRECTION OF THE NYS LICENSED AND REGISTERED ENGINEER THAT PREPARED THEM, IS A VIOLATION OF THE NYS EDUCATION LAW.

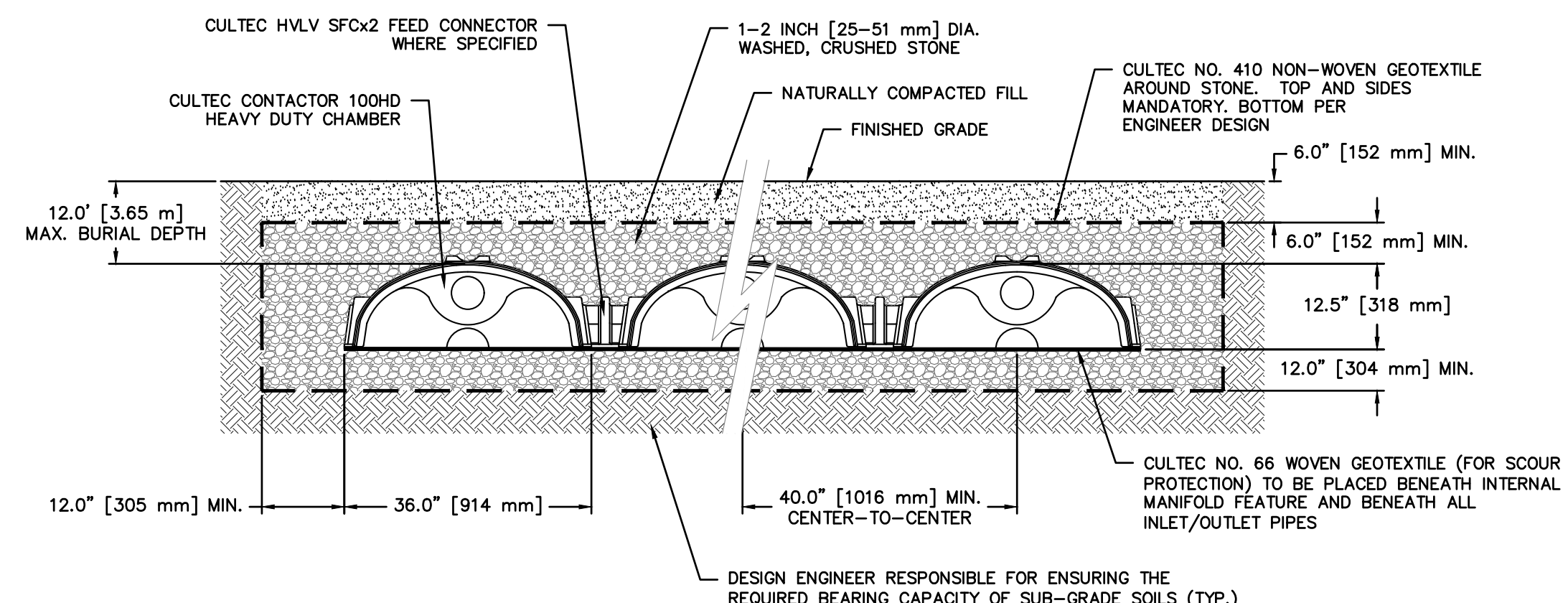

**GENERAL NOTES**  
 CONTACTOR 100HD BY CULTEC, INC. OF BROOKFIELD, CT. STORAGE PROVIDED = 3.84 CF/FT [0.82 M<sup>3</sup>/3] PER DESIGN UNIT. REFER TO CULTEC, INC.'S CURRENT RECOMMENDED INSTALLATION GUIDELINES.  
 MAXIMUM ALLOWED COVER ON TOP OF UNIT SHALL BE 12.0' [3.66 m] THE CHAMBER WILL BE DESIGNED TO WITHSTAND TRAFFIC LOADS.

**CULTEC CONTACTOR 100HD**

WHEN INSTALLED ACCORDING TO CULTEC'S RECOMMENDED INSTALLATION INSTRUCTIONS, ALL CONTACTOR 100HD HEAVY DUTY UNITS ARE MARKED WITH A COLOR STRIPE FORMED INTO THE PART ALONG THE LENGTH OF THE CHAMBER. ALL CONTACTOR 100 CHAMBERS MUST BE INSTALLED IN ACCORDANCE WITH ALL APPLICABLE LOCAL, STATE AND FEDERAL REGULATIONS.

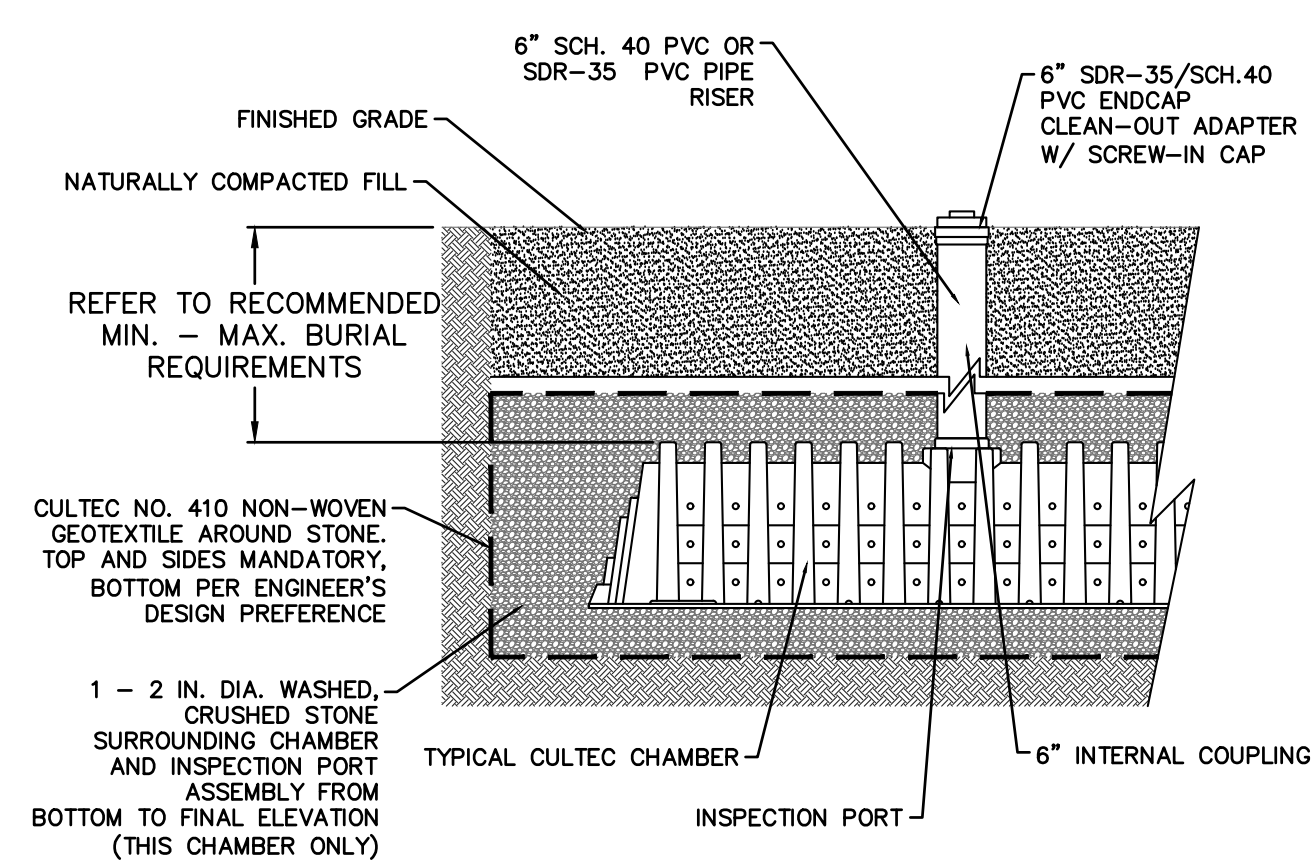

**CULTEC ACCESS PORT**

**STORMWATER MANAGEMENT FACILITIES MAINTENANCE PROGRAM**

MEASURE	DATES FOR INSPECTION	TIMING, ACTIVITY, AND LOCATION
GENERAL MAINTENANCE (STORM SEWER, CATCH BASINS/ DRAIN INLETS, MANHOLES AND PRE-TREATMENT DEVICE)	ALL	ALL STORMWATER FACILITIES SHALL BE INSPECTED IMMEDIATELY AFTER COMPLETION OF CONSTRUCTION, AND THEN MONTHLY FOR THE FIRST THREE (3) MONTHS FOLLOWING THE COMPLETION OF THE PROJECT. WITHIN THE FIRST THREE (3) MONTHS, INSPECTIONS SHALL IMMEDIATELY BE PERFORMED FOLLOWING A LARGE STORM EVENT (I.E. PRODUCING 1/2" (ONE-HALF INCH) OF RAIN OR GREATER). THEREAFTER, THESE FACILITIES SHALL BE INSPECTED AS DESCRIBED AS FOLLOWS. UPON INSPECTION, FACILITIES SHALL BE IMMEDIATELY MAINTAINED AND/OR CLEANED AS MAY BE REQUIRED. ANY SITE AREAS EXHIBITING SOIL EROSION OF ANY KIND SHALL BE IMMEDIATELY RESTORED AND STABILIZED WITH VEGETATION, MULCH OR STONE, DEPENDING ON THE AREA TO BE STABILIZED. UPON EACH INSPECTION, ALL VISIBLE DEBRIS INCLUDING, BUT NOT LIMITED TO, TWIGS, LEAF AND FOREST LITTER SHALL BE REMOVED FROM THE BASIN, OVERFLOW DISCHARGE POINTS AND FRAMES AND GRATES OF DRAINAGE STRUCTURES.
SUMPS - CATCH BASIN/DRAIN INLETS	UPON COMPLETION OF CONSTRUCTION -ONCE A MONTH FOR THE FIRST THREE (3) MONTHS -EVERY FOUR (4) MONTHS THEREAFTER	ALL CATCH BASIN/DRAIN INLETS WITH SUMPS HAVE BEEN DESIGNED TO TRAP SEDIMENT PRIOR TO ITS TRANSPORT TO THE INFILTRATION PRACTICE AND, ULTIMATELY, DOWNSTREAM. THESE SUMPS WILL REQUIRE PERIODIC INSPECTION AND MAINTENANCE TO ENSURE THAT ADEQUATE DEPTH IS MAINTAINED WITHIN THE SUMPS. THE OWNER, OR THEIR DULY AUTHORIZED REPRESENTATIVE, SHALL TAKE MEASUREMENTS OF THE SUMP DEPTH. IF SEDIMENT HAS ACCUMULATED TO 1/2 (ONE-HALF) THE DEPTH OF THE SUMP, ALL SEDIMENT SHALL BE REMOVED FROM THE SUMP. SEDIMENTS CAN BE REMOVED WITH HAND-LABOR OR WITH A VACUUM TRUCK. THE USE OF ROAD SALT SHALL BE MINIMIZED FOR MAINTENANCE OF ROADWAY AND DRIVEWAY AREAS.
SUBSURFACE INFILTRATION CHAMBERS/DRY WELL	UPON COMPLETION OF CONSTRUCTION -IMMEDIATELY AFTER CONSTRUCTION -EVERY SIX (6) MONTHS THEREAFTER (SPRING & FALL) BY INDIVIDUAL HOMEOWNERS	ALL INFILTRATION SYSTEMS SHALL BE INSPECTED EVERY SIX (6) MONTHS (SPRING AND FALL) FOR EXCESS SEDIMENT ACCUMULATION AND CLOGGING OF INLET AND OUTLET PIPING. DURING DRY WEATHER CONDITIONS, WHEN SEDIMENT HAS ACCUMULATED TO AN AVERAGE DEPTH EXCEEDING 3" (THREE INCHES), THE GALLERY SHALL BE WATER JETTED CLEAN, AND ALL ACCUMULATED SEDIMENTS SHALL BE VACUUMED OUT OR REMOVED MANUALLY. A STADIA ROD MAY BE INSERTED TO DETERMINE THE DEPTH OF THE SEDIMENT. MAINTENANCE OF THE INFILTRATION SYSTEMS LOCATED ON EACH INDIVIDUAL LOT SHALL BE THE RESPONSIBILITY OF THE INDIVIDUAL PROPERTY OWNER.

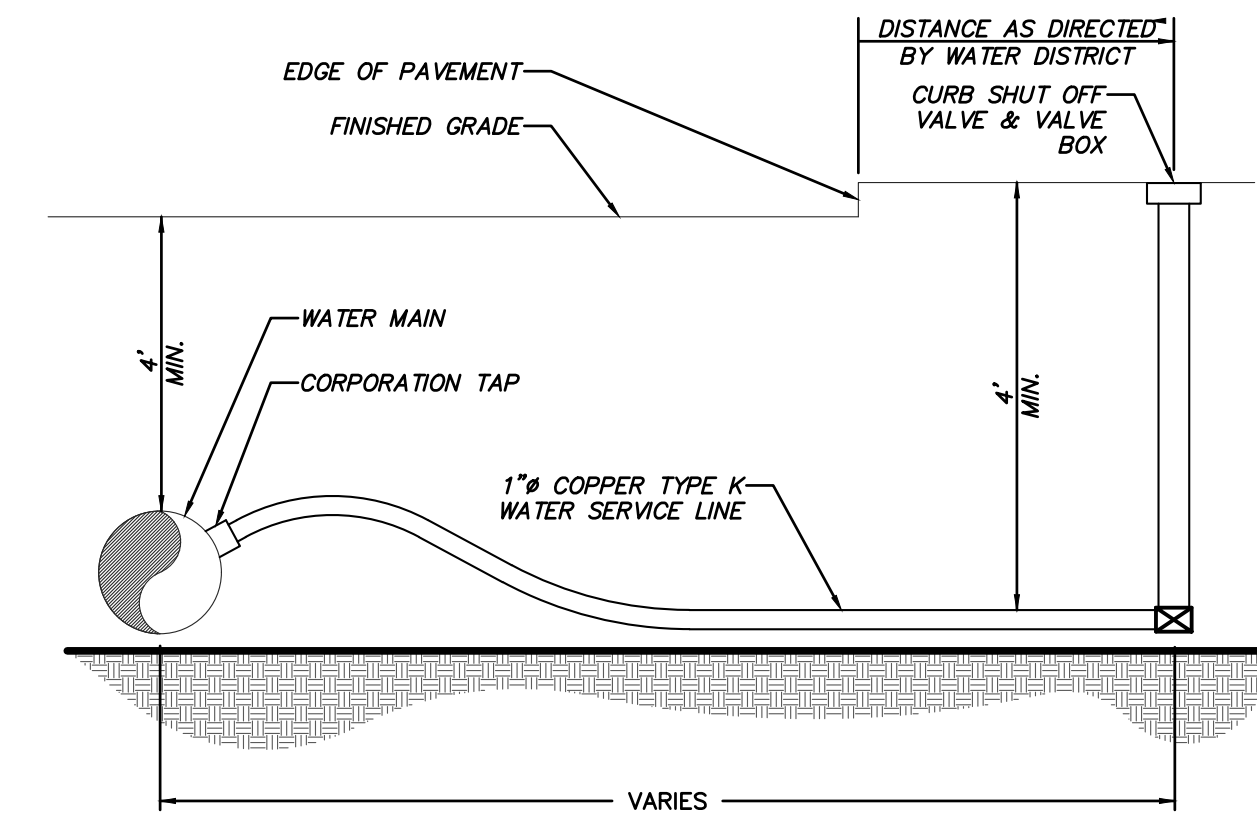

**NOTES:**

1. WATER DISTRICT TO FURNISH AND INSTALL CORPORATION TAP, SERVICE LINE, AND CURB SHUT OFF VALVE AND VALVE BOX.
2. CONTRACTOR TO EXCAVATE, MAINTAIN, BACKFILL, AND RESTORE TRENCH FOR THE TAP, SERVICE LINE, AND CURB SHUT OFF VALVE.
3. CONTRACTOR TO TAKE OUT PERMIT, PAY FEE, AND TO FOLLOW ALL RULES AND REGULATIONS OF THE LOCAL UTILITY AGENCY.

**WATER SERVICE LINE LATERAL DETAIL**

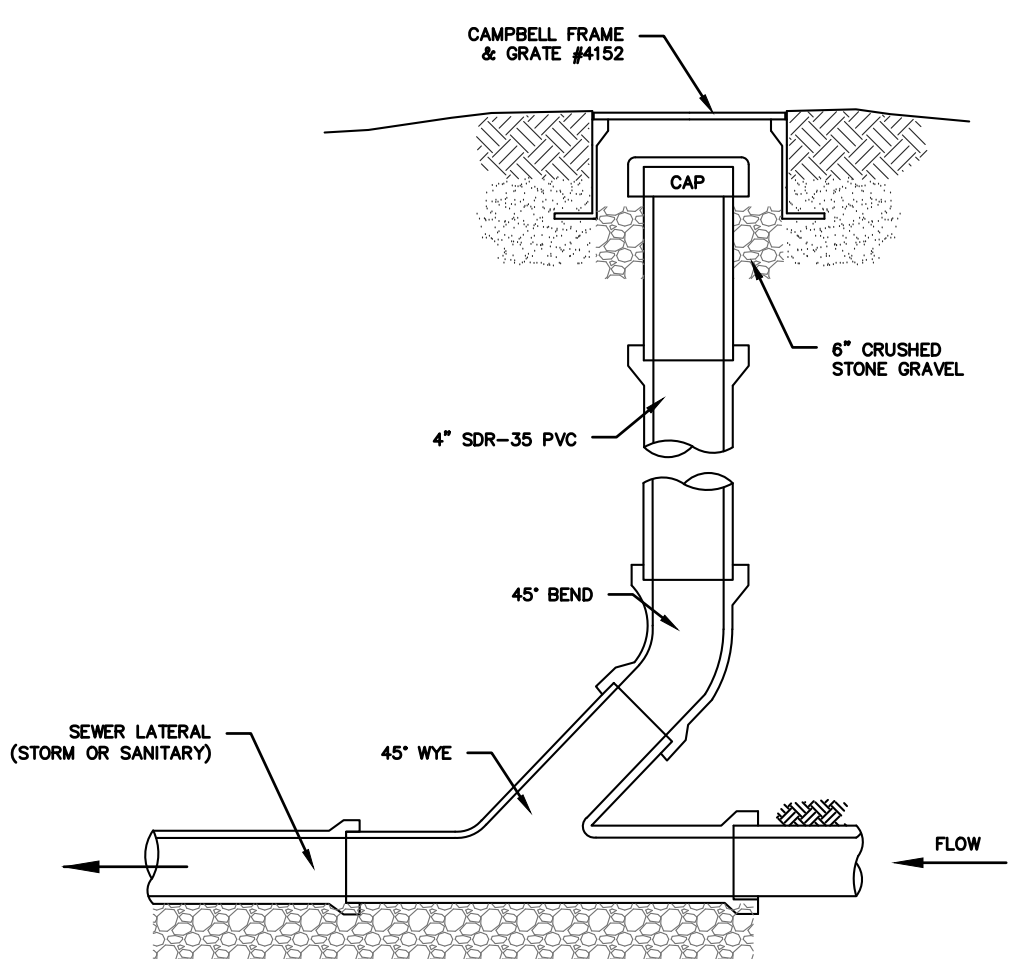

**NOTES (SANITARY SEWER SERVICES):**  
 1. ALL SANITARY SEWER SERVICES TO BE 4" SCH. 40 @ 1.0% MINIMUM.  
 2. IN ACCORDANCE WITH THE NYS RESIDENTIAL BUILDING CODE, THE FOLLOWING REQUIREMENTS APPLY:  
 A. CLEANOUTS SHALL BE INSTALLED NOT MORE THAN 100 FEET APART IN HORIZONTAL DRAINAGE LINES (P3005.2.2).  
 B. CLEANOUTS SHALL BE INSTALLED AT EACH CHANGE OF DIRECTION OF THE DRAINAGE SYSTEM GREATER THAN 45 DEGREES.  
 C. CLEANOUTS SHALL BE INSTALLED SO THAT THE CLEANOUT OPENS TO ALLOW CLEANING IN THE DIRECTION OF THE FLOW OF THE DRAINAGE LINE (P3005.2.B).  
**NOTES (STORM SEWER):**  
 1. REFER TO PLAN FOR SPECIFIC PIPE SIZING AND SLOPE SPECIFICATIONS; HOWEVER, IN GENERAL, ALL STORM SEWER SERVICES TO BE 6" SCH. 40 @ 1.0% MINIMUM.  
 2. CLEANOUTS SHALL BE PLACED BEFORE SIGNIFICANT PIPE BEND LOCATIONS (I.E., JUNCTIONS, 90-DEGREE BENDS, ETC.) UNLESS A ROOF LEADER DOWNSPOUT CONNECTION IS PROPOSED.

**SEWER CLEANOUT DETAIL (GRAVITY) (STORM OR SANITARY)**

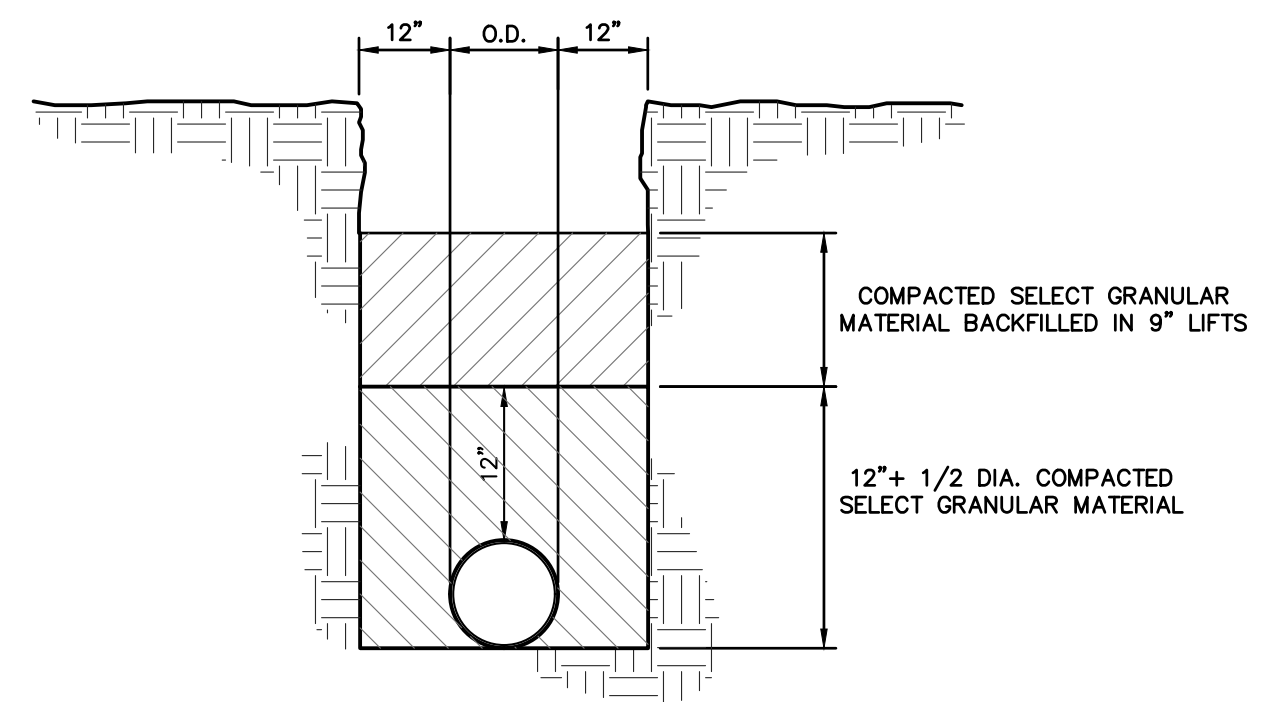

**TRENCH BEDDING**

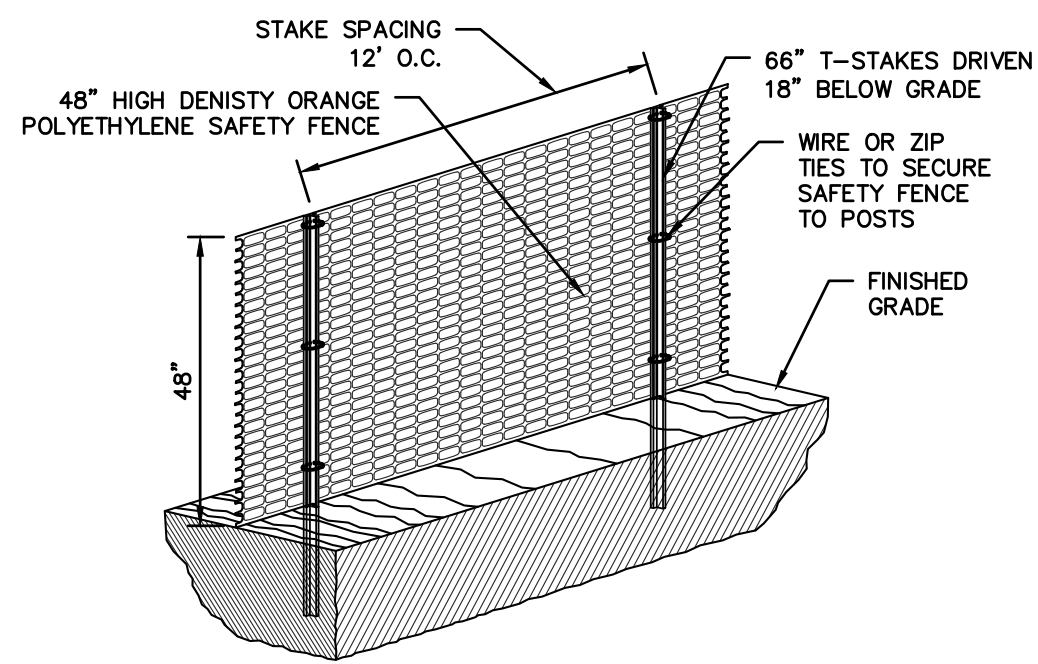

**CONSTRUCTION FENCE**

**NOTES:**

1. THE WASHOUT SHALL BE INSTALLED PRIOR TO USING MATERIALS THAT REQUIRE WASHOUT ON THIS PROJECT.
2. AS NECESSARY, SIGNS SHALL BE PLACED THROUGHOUT THE SITE TO INDICATE THE LOCATION OF THE WASHOUT.
3. THE WASHOUT AREA WILL BE REPLACED AS NECESSARY TO MAINTAIN CAPACITY FOR LIQUID WASTE.
4. WASHOUT RESIDUE SHALL BE REMOVED FROM THE SITE AND DISPOSED OF AT AN APPROVED WASTE FACILITY.
5. DO NOT WASHOUT INTO STORM DRAINS, OPEN DITCHES, STREETS, OR STREAMS.
6. AVOID DUMPING EXCESS CONCRETE IN NON-DESIGNATED DUMPING AREAS.
7. LOCATE WASHOUT AT LEAST 50' (15 METERS) FROM STORM DRAIN, OPEN DITCHES, OR WATER BODIES.
8. THE WASHOUT SHALL BE USED ONLY FOR NON-HAZARDOUS WASTES.

**CORRUGATED CONCRETE WASHOUT**

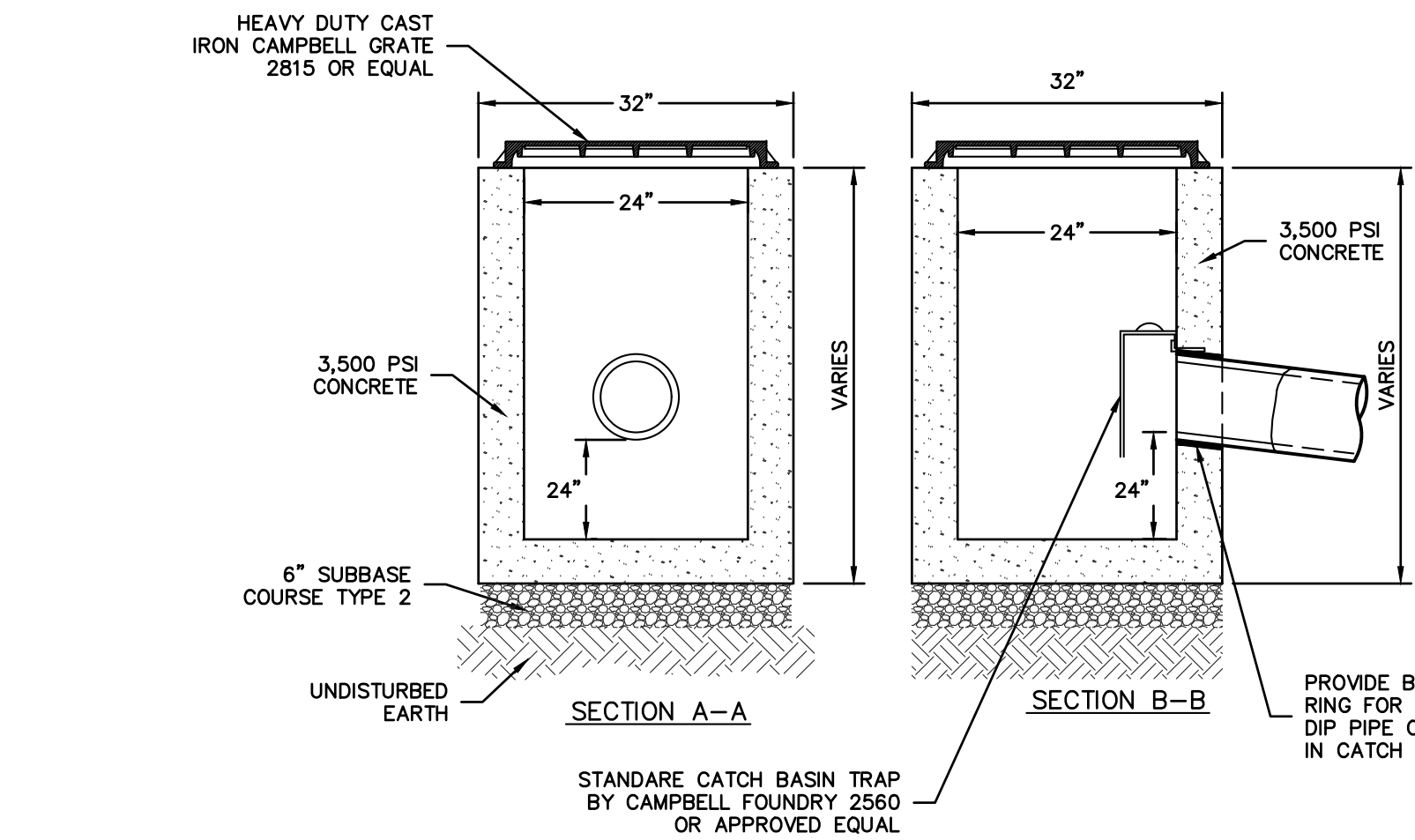

**NOTES:**  
 1. CONCRETE - 3,500 PSI MINIMUM STRENGTH @ 28 DAYS  
 2. DESIGN LOADING - AASHTO HS20-44  
 3. EARTH COVER - 0 TO 5 FEET  
 4. CONSTRUCTION JOINT - LAPPED

**24"x24" PRECAST CONCRETE CATCH BASIN**

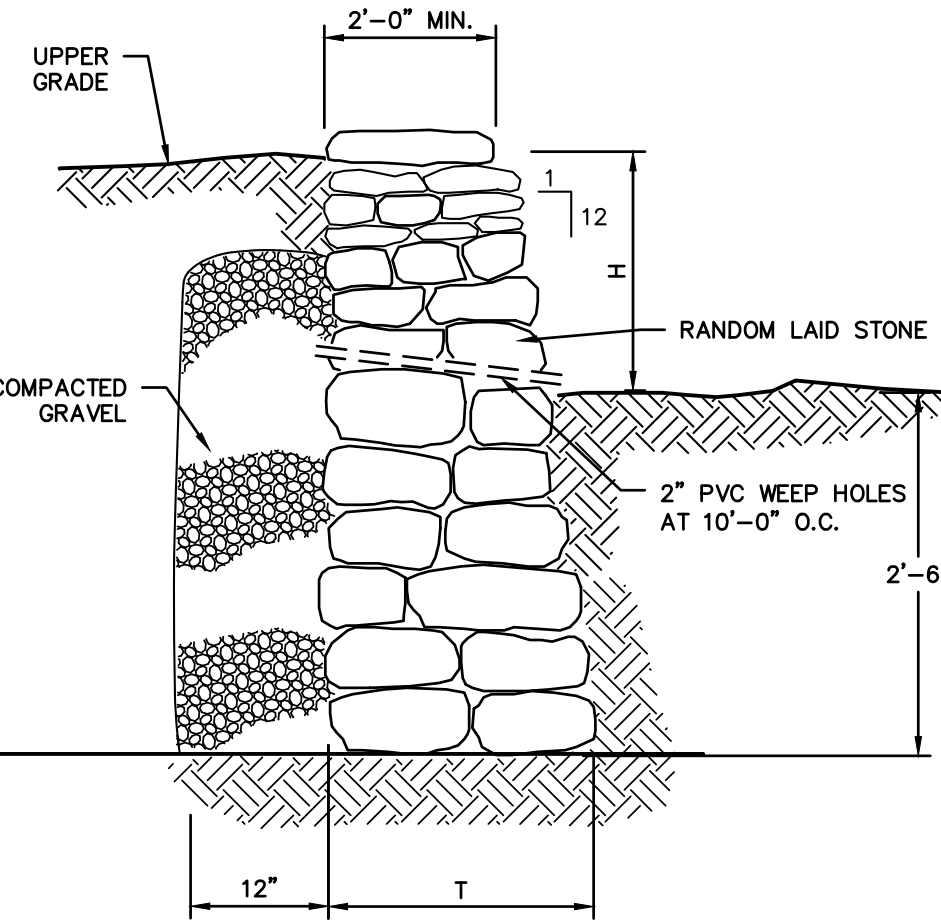

**FIELDSTONE RETAINING WALL**

**NOTE:**  
 1. "T" AT EVERY POINT MUST BE EQUAL OR GREATER THAN H/2.  
 2. THE FIELDSTONE WALLS DESIGN SHOULD ONLY BE USED FOR VERTICAL GRADE SEPARATIONS OF 6 FEET OR LESS ON SITE.

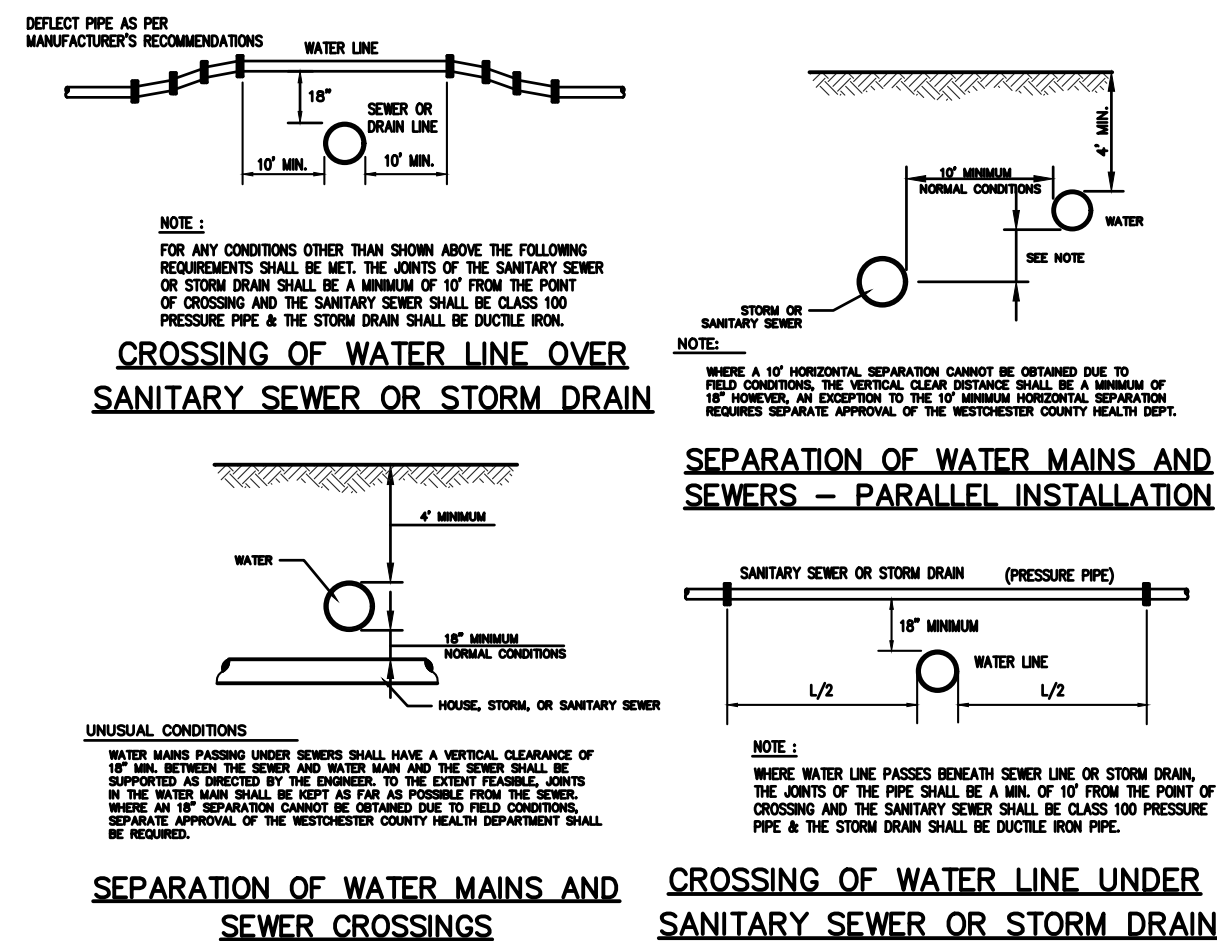

**SEWER SADDLE CONNECTION**

**NOTES:**  
 1. ALL HARDWARE SHALL BE STAINLESS STEEL.  
 2. CONNECTION SHALL BE MADE IN ACCORDANCE WITH MANUFACTURER'S REQUIREMENTS AND INSTRUCTIONS.  
 3. CONNECTION ANGLE SHALL BE BETWEEN 22.5° AND 45°.

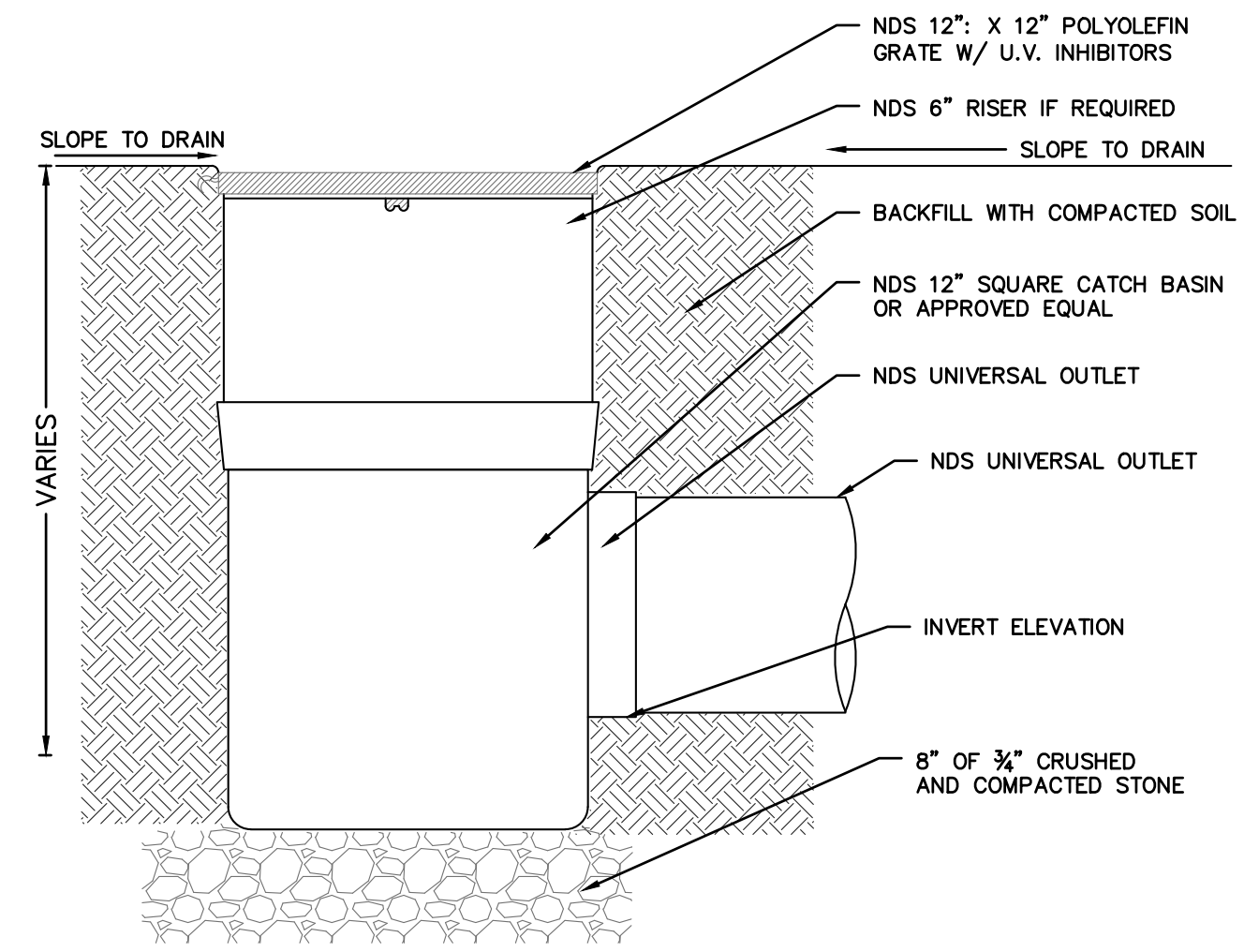

**NDS SQUARE CATCH BASIN**

**DRIVEWAY PAVEMENT SECTION**  
 A - 2" TOP COURSE - N.Y.S.D.O.T. ITEM, TYPE 6 F2  
 B - 4" SUBBASE COURSE - N.Y.S.D.O.T. ITEM, TYPE 2

REVISIONS NO. DATE DESCRIPTION 1 03/07/22 2 03/07/22 3 03/07/22	PROJECT: <b>PROPOSED DWELLING          13 DELLWOOD LANE          VILLAGE OF ARDSLEY          WESTCHESTER COUNTY - NEW YORK</b>	
THIS PLAN NOT VALID FOR CONSTRUCTION WITHOUT ENGINEER'S SEAL & SIGNATURE	<b>DETAILS</b> <b>HUDSON ENGINEERING CONSULTING, P.C.</b> 45 Knollwood Road, Suite 201 Elmford, New York 10523 T: 914-909-0420 F: 914-560-2086	Date: 07/07/21 Scale: N.T.S. Designed By: U.A. Checked By: M.S. Sheet No. 3

ANY ALTERATIONS OR REVISIONS OF THESE PLANS, UNLESS DONE BY OR UNDER THE DIRECTION OF THE NYS LICENSED AND REGISTERED ENGINEER THAT PREPARED THEM, IS A VIOLATION OF THE NYS EDUCATION LAW.